



# Quick guide to Placer County's cannabis ordinance

Effective Jan. 1, 2017



Cultivation allowed only on land with private residence, not on vacant land. Indoor grows allowed in either a residence or a secure accessory structure.

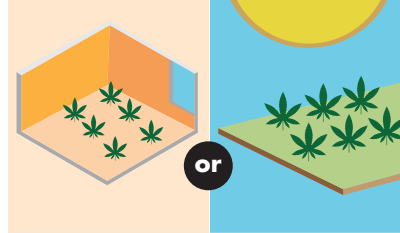

Cultivation limit is 6 plants on no more than 50 square feet for recreational use and no more than 50 square feet for medicinal use. Either indoor or outdoor gardens allowed but not both.

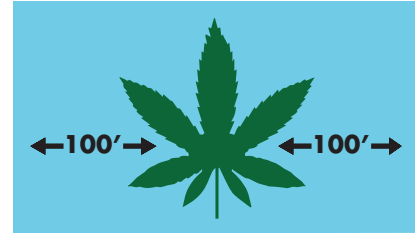

Outdoor grows must be set back at least 100 feet from all property lines.



Outdoor cannabis must be more than 600 feet from any school, church, park, library, fairgrounds, child care center, youth-oriented facility or incorporated city boundary.

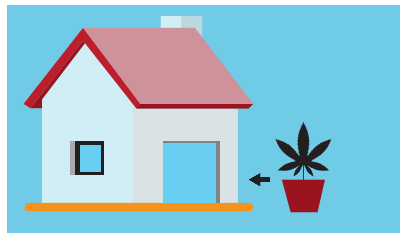

Outdoor cultivation must be closer to grower residence than any neighboring residence.



Tenants must have written permission from property owner to grow cannabis.

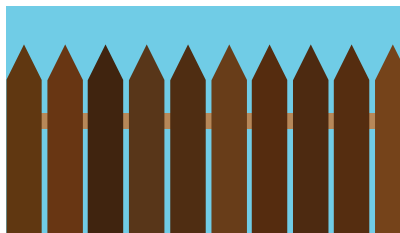

All outdoor grows must be screened with fencing to prevent viewing from the public or adjoining property owners.



Outdoor cultivation shall not adversely affect health and safety of occupants, neighbors or members of the public with dust, glare, noise, odor, smoke, traffic, etc.

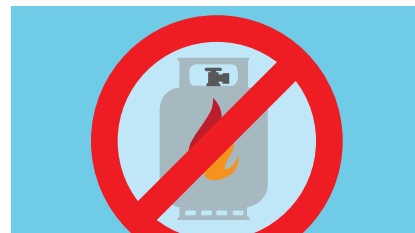

Use of gas products (Co2, butane, propane, etc.) for grows or manufacturing is prohibited.



Grows must comply with building, plumbing, mechanical, electrical and fire codes.



Commercial sale, manufacturing, dispensaries and delivery of cannabis are prohibited. Delivery of medicinal products by a primary caregiver to a qualified patient is permissible.



First time violators have 72 hours to comply with ordinance guidelines before being subjected to fines. See reverse for penalties.

## Cannabis Grows Property Setback Diagram

### 2.5 acre parcel with 100 foot setback

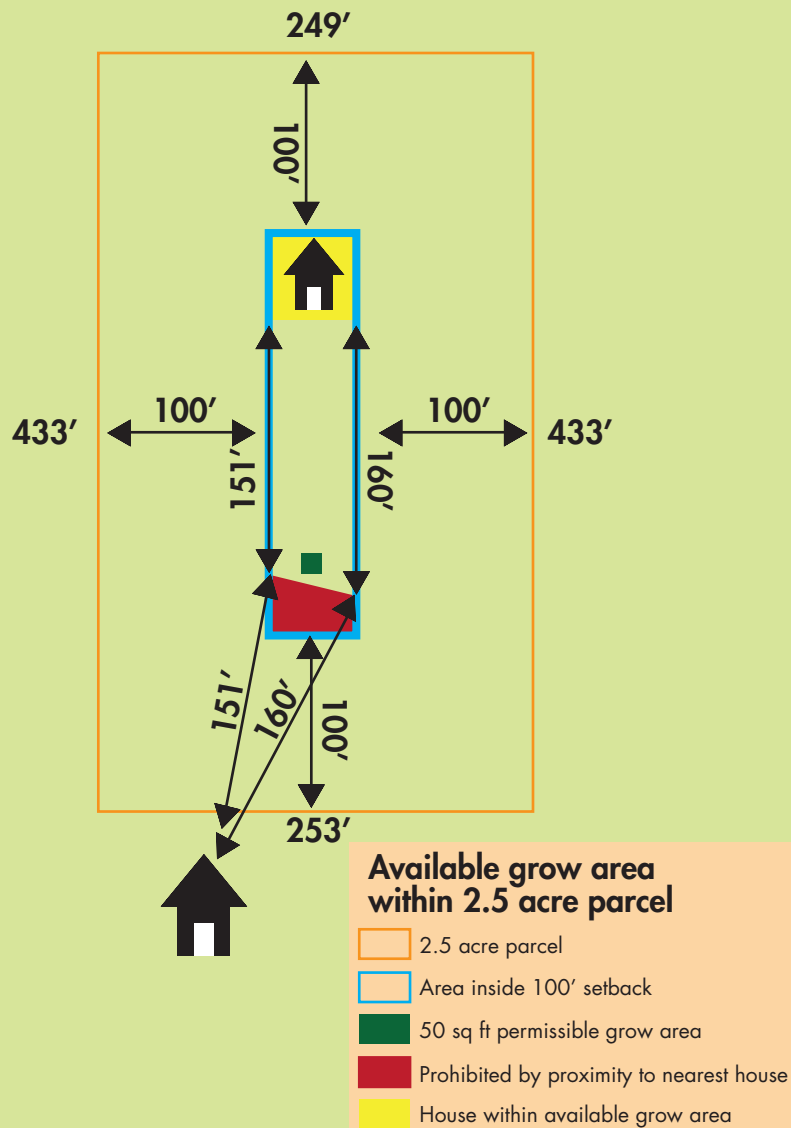

## Cannabis Grows Penalties

### Indoor/Outdoor Cannabis Grows Penalties

- \$500 fine per plant over the permissible recreational use limit (not applicable to medicinal use)
- \$500 fine for every 25 square feet over the permissible 50 square foot garden area  
Fines increase to \$1,000 per plant/25 square feet if unresolved within the 72-hour notice period
- \$1,000 fine per plant and up to \$5,000 per day for prohibited commercial activities including cultivation, manufacture or distribution
- Separate violation of \$500 for prohibited cannabis delivery activity

Growers with no prior offenses who comply with the 72-hour notice may have fines and costs waived; however, many fines double if compliance is not achieved in 72 hours.

### For questions contact:

Placer County Code Compliance main line: 530-745-3050

Placer County Agricultural Commissioner: 530-889-7372