

**ALTERNATIVE 5 - ROADWAY CROSS SECTION:**

- 1 - 3.6 m (12') TRAFFIC LANE EASTBOUND
  - 2 - 3.6 m (12') TRAFFIC LANES WESTBOUND
  - 1 - 3.6 m (12') DUAL CENTER TURN LANE
  - 1 - 1.5 m (5') BIKE LANE EACH DIRECTION
  - 1 - 2.4 m (8') PARKING LANE WESTBOUND
  - 1 - 2.3 m (7½) SIDEWALK/PLANTING AREA EACH DIRECTION
- (SEE SHEET 27 FOR TYPICAL X-SECTION - ALTERNATIVE 5)  
 (SEE SHEET 26 FOR DOUBLE ROUNDABOUT)



REVISION #	DATE	DESCRIPTION AND SHEET NO.	APPROVED BY:	DATE:

THE COUNTY OF PLACER OR ITS OFFICERS OR AGENTS SHALL NOT BE RESPONSIBLE FOR THE ACCURACY OR COMPLETENESS OF ELECTRONIC COPIES OF THIS PLAN SHEET.

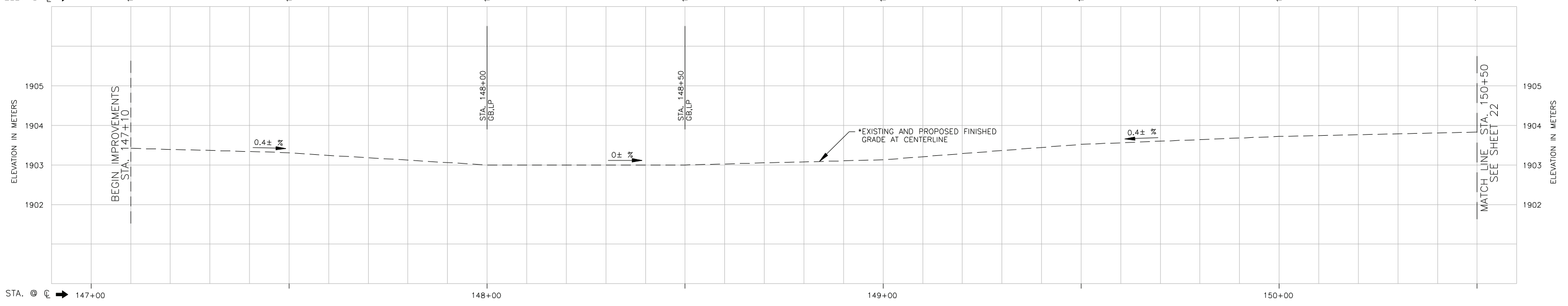
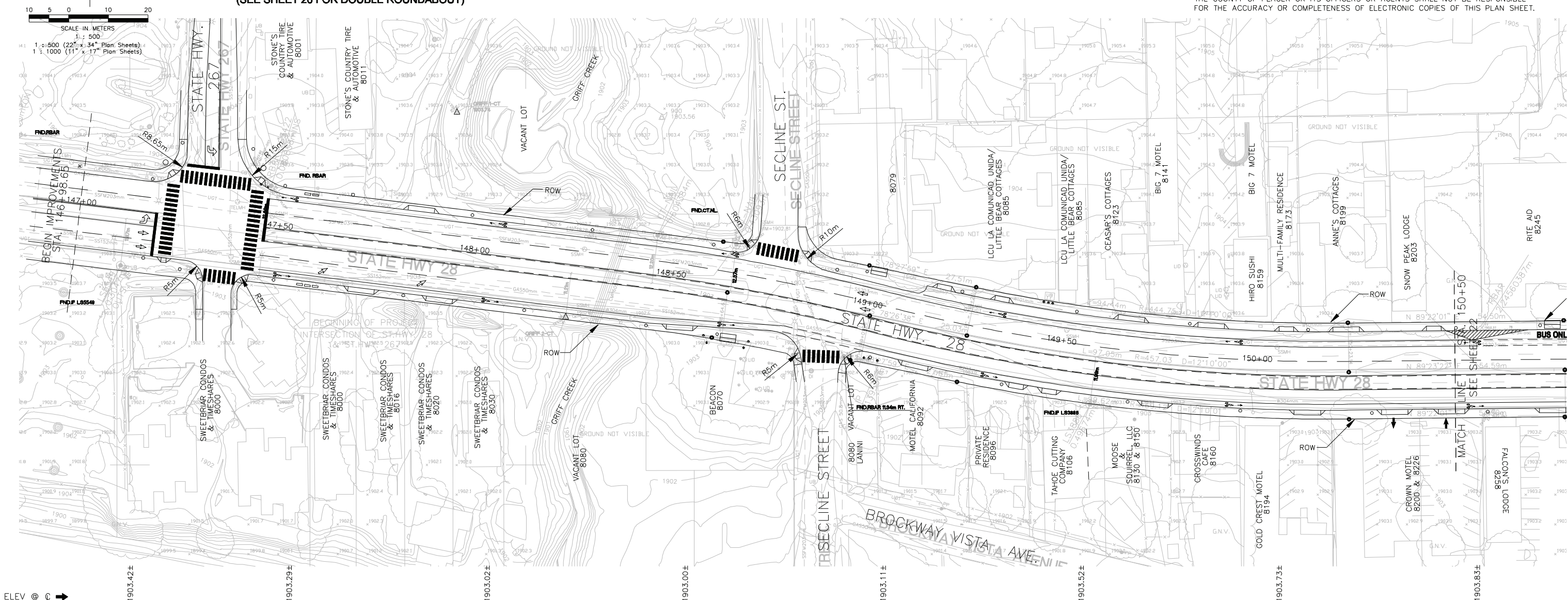

**Figure 2-6 Kings Beach Commercial Core Improvement Project Rejected Alternative 5**

PLAN SCALE: 1:500  
 PROFILE SCALE: 1:500  
 HORIZ: 1:500  
 VERT: 1:50

DESIGNED: BRS  
 DRAWN: BRS  
 CHECKED: RTL  
 RECORDED: BRS  
 DATE: 12/01/06  
 CONTRACT NO. 73108

DEPARTMENT OF PUBLIC WORKS  
 COUNTY OF PLACER  
**KINGS BEACH COMMERCIAL CORE IMPROVEMENT PROJECT**  
 FEASIBILITY STUDY - ALTERNATIVE 5 - PLAN, PROFILE & STRIPING LAYOUT